



Eden Way, London, E3

BUTLER & STAG



Guide Price £550,000 - £600,000
Set just south of Victoria Park and Regent's Canal, this two-bedroom garden maisonette is nestled on a leafy car-free street. Taking inspiration from white-washed Mediterranean architecture, Eden Way is an award winning project by local architect, Peter Barber.



Leasehold

- Garden Maisonette
- Two Well Proportioned Double Bedrooms
- Award-Winning Mediterranean Inspired Architecture
- Bright Open Plan Living Space
- Private Garden
- Set On A Quiet Leafy Car-Free Street

The home features a bright and airy open plan living area complimented by large expansive windows and patio doors that fill the space with natural light throughout the day. The patio doors open out onto a private garden that extends the living space outside.

There are two well-proportioned double bedrooms, each offering excellent comfort and storage options, alongside a smartly presented bathroom.

Completed in 2006, the development was selected from 150 entries worldwide as the winner of the Architecture Foundation's Innovations in Housing Competition. It was runner-up in the Royal Academy Summer Exhibition, AIA Award, and RIBA Award. It was shortlisted for the 2006 Stirling Prize and included in the exhibition of 50 of the most significant UK buildings of the last half-century.

Eden Way is located a brisk walk from Victoria Park and Regent's Canal, and a short walk from Hackney Wick. It's convenient for the Mildmay line, the District line, the DLR, and the No. 8 bus.





Eden Way, E3

Approx Gross Internal Area : 61.6 sq m / 663 sq ft

BUTLER & STAG

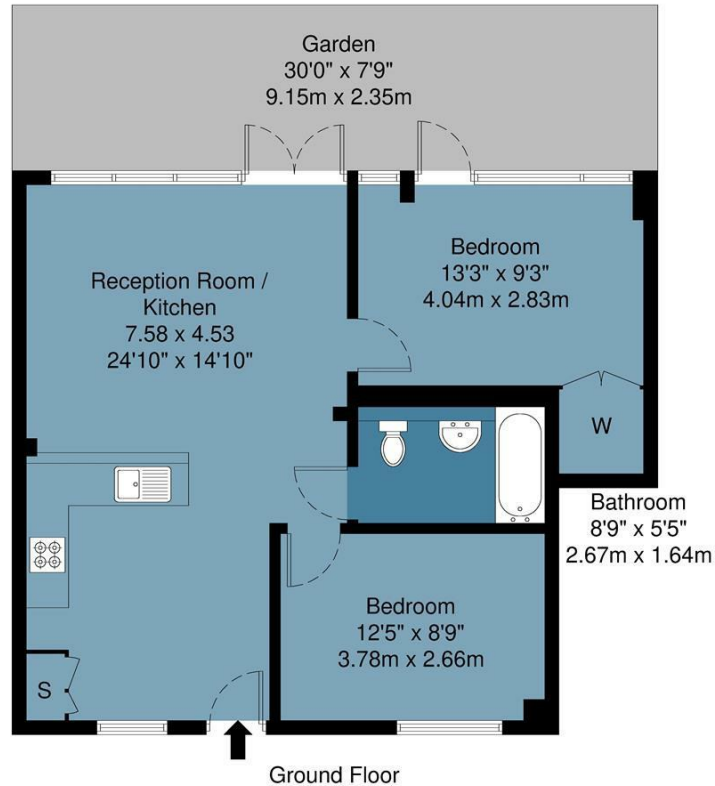
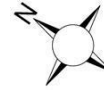

Measurements are approximate and for illustration purposes only. While we do not doubt the accuracy and completeness, we advise you conduct a careful independent assessment of the property to determine monetary value.
© @ Maison VUE | www.maisonvue.com

BUTLER & STAG

☎ 020 8102 1236

🏠 508 Roman Road, Bow, London, E3 5LU

✉ bow@butlerandstag.com

IMPORTANT NOTICE - These particulars have been prepared in good faith and they are not intended to constitute part of an offer or contract. We have not performed a structural survey on this property and the services, appliances and specific fittings have not been tested. All photographs, measurements, floor plans and distances referred to are given as a guide and should not be relied upon.

www.butlerandstag.uk